

Suggested Uniform Load

Pre Galvanised 41x21x2.5mm slotted strut
Loading Conditions: UDL

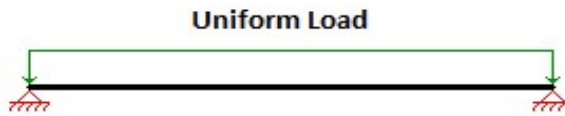
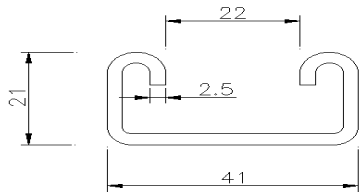

Slotted 41x21x2.5mm thick

Beam Span (mm)	Ultimate Loading		Limit Def. Span/200		Limit Def. Span/360	
	Total Applied Load (kg)	Total Def. (mm)	Applied UDL (KG)	Total Def. (mm)	Applied UDL (kg)	Total Def. (mm)
250	560	0.5				
500	310	2.0			210	1.4
750	205	4.5	170	3.8	95	2.1
1000	153	8.0	95	5.0	53	2.8
1250	120	12.4	60	6.3	32	3.5
1500	99.5	17.9	40.1	7.5	21.2	4.2
1750	84.6	24.4	28.6	8.8	14.6	4.9
2000	73.6	32.0	20.7	10.0	10.1	5.6
2250	64.8	40.5	15.3	11.3	6.9	6.3
2500	57.7	50.2	11.2	12.5	4.3	6.9
2750	51.7	60.8	8.2	13.8	2.4	7.6
3000	46.7	72.5	5.7	15.0		
3250	42.5	85.4	3.7	16.3		
3500	38.7	99.2	1.995	17.5		
3750	35.45	114.2				
4000	32.6	130.5				
4250	29.95	147.7				
4500	27.6	166.2				
4750	25.48	185.9				
5000	23.5	206.7				
5250	21.71	229.0				
5500	20	252.1				
5750	18.4	276.4				
6000	17	303.0				