



BLUE-TIP 2 SCREW-BOLTS™

HIGH PERFORMANCE, ONE-PIECE DESIGN CONCRETE SCREWS

Our **BLUE-TIP 2 SCREW-BOLTS™** are one-piece, heavy duty concrete screws with ETA Option 1 approval, additional Part 6 approval on 6mm diameters*.

These concrete screws have been redesigned to ensure a simple installation with greatly improved loading capacities every time.

The **BLUE-TIP 2 SCREW-BOLTS™** features a patented thread, designed for use with standard metric drill bits, which reduces installation torque and increases productivity.

The patented thread taps into the hole during installation to provide keyed engagement and to allow for reduced edge and spacing distances.

The range includes both hexagonal and domed heads, in lengths from 30mm to 200mm and diameters of 6 to 16mm, ensuring that there is a **BLUE-TIP 2 SCREW-BOLTS™** for all applications.

- ETA Option 1 approved for cracked and uncracked concrete
- ETA Part 6 approved on 6mm diameters*
- Fire rated to F120
- Patented thread for easy installation and increased productivity
- Approved for small spacing and edge distances

* Excludes 6 x 30mm screw-bolt

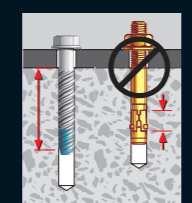

Grips over the total anchor length



One piece design



HEX HEAD



DOMED HEAD



HANGERMATE™

BLUE-TIP 2 SCREW-BOLTS™

APPLICATIONS

- Racking and shelving
- Temporary supports
- Fencing
- Railings and handrails
- Stadium seating
- Fastening steel and metal base plates to concrete

MATERIALS

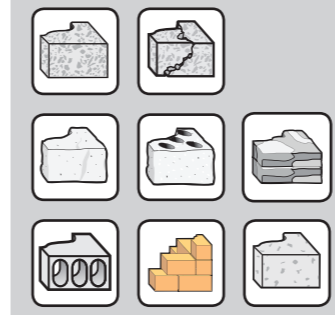

See front cover foldout for details.

APPROVALS



PRODUCT OVERVIEW - HEX HEAD ZINC PLATED

NEW



Cat No.	ETA		A	B	Drill Dia. [mm]	Length [mm]	Head Size [mm]	Max t _{ix} [mm]	Box	Blister Pack	Pack Qty
	1	2									
DFM1430001					6x30	10mm	5mm		•		100
DFM143001P					6x30	10mm	5mm			•	4
DFM1430002	•	•	•	•	6x50	10mm	10mm		•		100
DFM143003S	•	•	•	•	6x60	10mm	20mm		•		50
DFM1430003	•	•	•	•	6x60	10mm	20mm		•		100
DFM143003P	•	•	•	•	6x60	10mm	20mm			•	4
DFM143004S	•	•	•	•	6x80	10mm	40mm		•		50
DFM143004P	•	•	•	•	6x80	10mm	40mm			•	4
DFM1430004	•	•	•	•	6x100	10mm	60mm		•		100
DFM143005S	•	•	•	•	6x100	10mm	60mm		•		50
DFM143005P	•	•	•	•	6x100	10mm	60mm			•	4
DFM1430006					8x50	13mm	5mm		•		50
DFM1430007	•		•	•	8x75	13mm	25mm		•		50
DFM143007P	•		•	•	8x75	13mm	25mm			•	4
DFM143008S	•		•	•	8x100	13mm	50mm		•		25
DFM1430008	•		•	•	8x100	13mm	50mm		•		50
DFM143008P	•		•	•	8x100	13mm	50mm			•	4
DFM1430009					10x60	17mm	5mm		•		50
DFM143009P					10x60	17mm	5mm			•	2
DFM143010S	•		•	•	10x75	17mm	15mm		•		25
DFM1430010	•		•	•	10x75	17mm	15mm		•		50
DFM143010P	•		•	•	10x75	17mm	15mm			•	2
DFM143011S	•		•	•	10x100	17mm	40mm		•		25
DFM1430011	•		•	•	10x100	17mm	40mm		•		50
DFM143011P	•		•	•	10x100	17mm	40mm			•	2
DFM1430012	•		•	•	10x120	17mm	60mm		•		25
DFM143012P	•		•	•	10x120	17mm	60mm			•	2
DFM1430013	•		•	•	10x140	17mm	80mm		•		25
DFM1430014	•		•	•	10x160	17mm	100mm		•		20
DFM1430015					12x75	19mm	5mm		•		25
DFM143015P					12x75	19mm	5mm			•	2
DFM1430016	•		•	•	12x100	19mm	25mm		•		25
DFM143016P	•		•	•	12x100	19mm	25mm			•	2
DFM1430017	•		•	•	12x150	19mm	75mm		•		20
DFM143017P	•		•	•	12x150	19mm	75mm			•	2
DFM1430018					14x80	21mm	5mm		•		25
DFM1430019	•		•	•	16x100	23mm	5mm		•		20
DFM1430020	•		•	•	16x130	23mm	35mm		•		10
DFM1430021	•		•	•	16x150	23mm	55mm		•		10
DFM1430022	•		•	•	16x200	23mm	105mm		•		10

BLUE-TIP 2 SCREW-BOLTS™

MECHANICAL ANCHORS

INSTALLATION INSTRUCTIONS

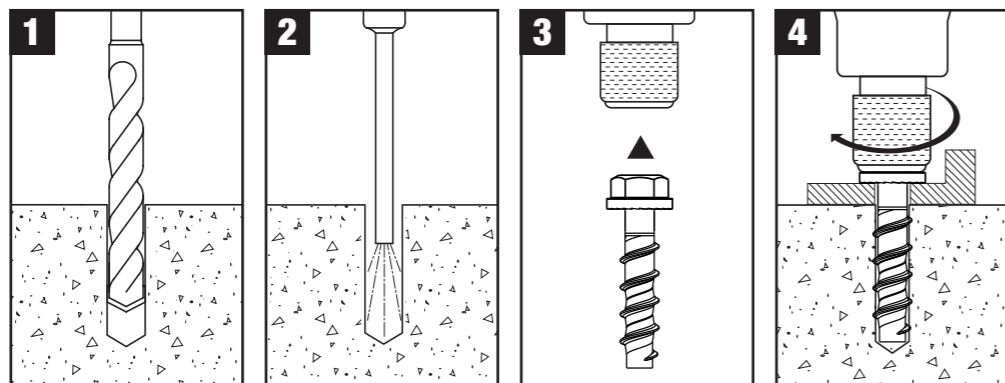

TECHNICAL INFORMATION

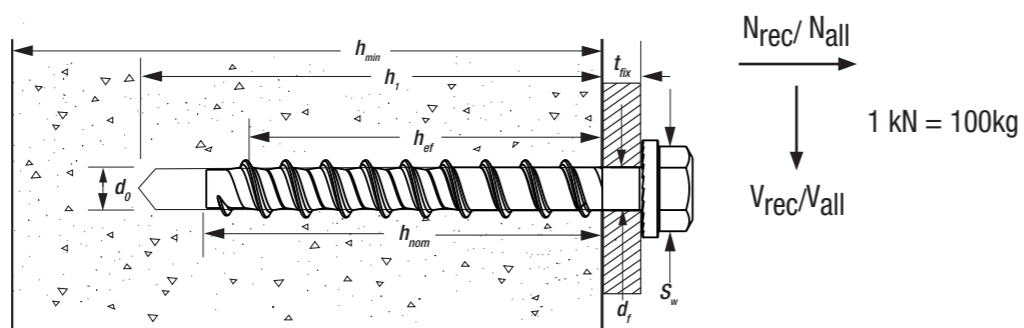

RECOMMENDED LOADS - UNCRACKED CONCRETE - BLUE-TIP 2 HEX HEAD ZINC PLATED



$$\frac{N_{Rk}}{\gamma_M \cdot \gamma_F} = N_{all}$$

$\gamma_f = 1.4$

Size - Thread x L [mm]	h_{nom} [mm]	h_1 [mm]	d_f [mm]	Max t_{fix} [mm]	N_{rec} [kN]	V_{rec} [kN]
6 x 30	25	35	9	5	1.0	1.0
8 x 50	45	55	12	5	3.0	3.0
10 x 60	55	65	14	5	4.0	6.0
12 x 75	70	80	16	5	5.5	9.5
14 x 80	75	85	18	5	7.0	14.0

BLUE-TIP 2 SCREW-BOLTS™

ALLOWABLE LOADS - UNCRACKED CONCRETE - BLUE-TIP 2 HEX HEAD ZINC PLATED



$$\frac{N_{Rk}}{\gamma_M \cdot \gamma_F} = N_{all}$$

$\gamma_f = 1.4$

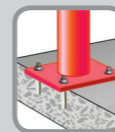

Size - $d_o \times L$ [mm]	h_{nom} [mm]		h_1 [mm]		d_f [mm]	t_{fix} [mm]		N_{all} [kN]		V_{all} [kN]	
	min	max	min	max		min h_{nom}	max h_{nom}	min	max	min	max
6 x 50	40		50		9	10		2.6		2.3	
6 x 60	40	55	50	65	9	20	5	2.6	4.8	2.3	3.6
6 x 80	40	55	50	65	9	40	25	2.6	4.8	2.3	3.6
6 x 100	40	55	50	65	9	60	45	2.6	4.8	2.3	3.6
8 x 75	50		60		12	25		4.8		4.6	
8 x 100	50	75	60	85	12	50	25	4.8	7.9	4.6	7.0
10 x 75	60		70		14	15		7.1		7.1	
10 x 100	60	85	70	95	14	40	15	7.1	10.6	7.1	10.6
10 x 120	60	85	70	95	14	60	35	7.1	10.6	7.1	10.6
10 x 140	60	85	70	95	14	80	55	7.1	10.6	7.1	10.6
10 x 160	60	85	70	95	14	100	75	7.1	10.6	7.1	10.6
12 x 100	75		85		16	25		8.4		8.4	
12 x 150	75	100	85	110	16	75	50	8.4	16.1	8.4	18.9
16 x 100	95		105		18	5		11.6		23.3	
16 x 130	95		105		18	35		11.6		23.3	
16 x 150	95	130	105	140	18	55	20	11.6	16.9	23.3	33.8
16 x 200	95	130	105	140	18	105	70	11.6	16.9	23.3	33.8

ALLOWABLE LOADS - CRACKED CONCRETE - BLUE-TIP 2 HEX HEAD ZINC PLATED



$$\frac{N_{Rk}}{\gamma_M \cdot \gamma_F} = N_{all}$$

$\gamma_f = 1.4$

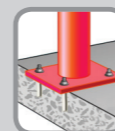

Size - $d_o \times L$ [mm]	h_{nom} [mm]		h_1 [mm]		d_f [mm]	t_{fix} [mm]		N_{all} [kN]		V_{all} [kN]	
	min	max	min	max		min h_{nom}	max h_{nom}	min	max	min	max
6 x 50	40		50		9	10		1.2		2.0	
6 x 60	40	55	50	65	9	20	5	1.2	1.8	2.0	3.6
6 x 80	40	55	50	65	9	40	25	1.2	1.8	2.0	3.6
6 x 100	40	55	50	65	9	60	45	1.2	1.8	2.0	3.6
8 x 75	50		60		12	25		0.9		3.9	
8 x 100	50	75	60	85	12	50	25	0.9	3.6	3.9	6.2
10 x 75	60		70		14	15		2.4		5.0	
10 x 100	60	85	70	95	14	40	15	2.4	4.4	5.0	10.6
10 x 120	60	85	70	95	14	60	35	2.4	4.4	5.0	10.6
10 x 140	60	85	70	95	14	80	55	2.4	4.4	5.0	10.6
10 x 160	60	85	70	95	14	100	75	2.4	4.4	5.0	10.6
12 x 100	75		85		16	25		5.6		5.9	
12 x 150	75	100	85	110	16	75	50	5.6	7.1	5.9	18.9
16 x 100	95		105		18	5		4.0		16.3	
16 x 130	95		105		18	35		4.0		16.3	
16 x 150	95	130	105	140	18	55	20	4.0	9.5	16.3	23.6
16 x 200	95	130	105	140	18	105	70	4.0	9.5	16.3	23.6

MECHANICAL ANCHORS

BLUE-TIP 2 SCREW-BOLTS™

APPLICATIONS

- Fencing
- Handrails
- Ornamental steelwork

MATERIALS



See front cover foldout for details.

APPROVALS



PRODUCT OVERVIEW - **DOME HEAD ZINC PLATED**

NEW



Cat No.	ETA		A	B	Drill Dia. [mm]	Length [mm]	Head Size [mm]	Max t _{fix} [mm]	Box	Blister Pack	Pack Qty
	1	2									
DFM1440001		•	•		6x40	T30	5mm		•		100
DFM144001P		•	•		6x40	T30	5mm			•	4
DFM1440002	•	•	•	•	6x50	T30	10mm		•		100
DFM1440003	•	•	•	•	6x65	T30	25mm		•		100
DFM144003P	•	•	•	•	6x65	T30	25mm			•	4

INSTALLATION INSTRUCTIONS

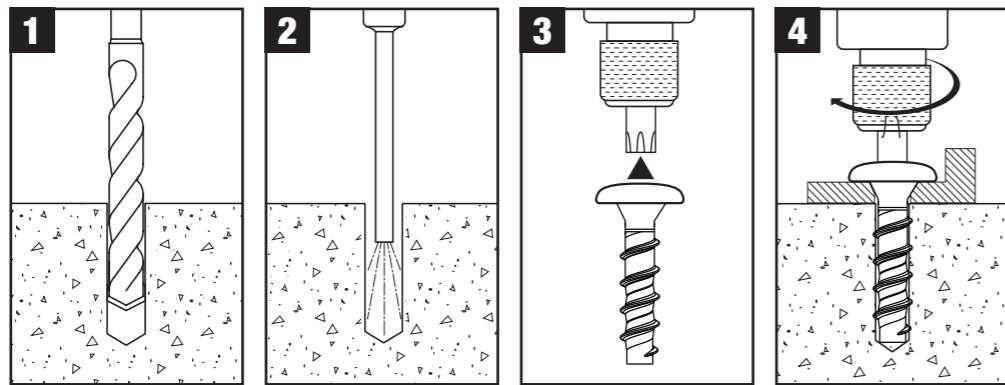

TECHNICAL INFORMATION

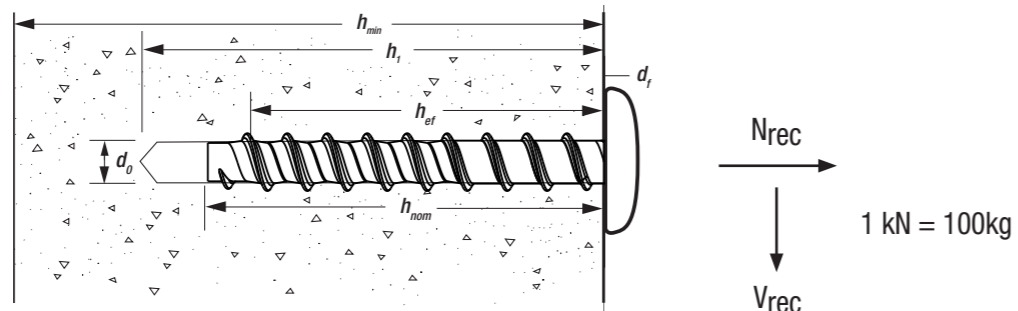

BLUE-TIP 2 SCREW-BOLTS™

ALLOWABLE LOADS - UNCRACKED CONCRETE - **BLUE-TIP 2 DOME HEAD ZINC PLATED**

$$\frac{N_{Rk}}{\gamma_M \cdot \gamma_F} = N_{all}$$

$\gamma_f = 1.4$

Size - d ₀ x L [mm]	h _{nom} [mm]		h ₁ [mm]		d _f [mm]	t _{fix} [mm]		N _{all} [kN]		V _{all} [kN]	
	min	max	min	max		min h _{nom}	max h _{nom}	min	max	min	max
6x40	35	-	45	-	9	5	-	1.8	-	1.8	-
6x50	40	-	50	-	9	10	-	2.6	-	2.3	-
6x65	40	55	50	65	9	25	10	2.6	4.8	2.3	3.6

ALLOWABLE LOADS - CRACKED CONCRETE - **BLUE-TIP 2 DOME HEAD ZINC PLATED**

$$\frac{N_{Rk}}{\gamma_M \cdot \gamma_F} = N_{all}$$

$\gamma_f = 1.4$

Size - d ₀ x L [mm]	h _{nom} [mm]		h ₁ [mm]		d _f [mm]	t _{fix} [mm]		N _{all} [kN]		V _{all} [kN]	
	min	max	min	max		min h _{nom}	max h _{nom}	min	max	min	max
6x40	35	-	45	-	9	5	-	1.8	-	1.8	-
6x50	40	-	50	-	9	10	-	1.2	-	2.0	-
6x65	40	55	50	65	9	25	10	1.2	1.8	2.0	3.6



HANGERMATE™ ROD HANGERS

HIGH PERFORMANCE, ONE-PIECE DESIGN CONCRETE HANGER SCREWS

HANGERMATE™ rod are a one-piece, heavy duty concrete screw with ETA Option 1 approval, featuring M8 or M10 internally threaded heads.

The internally threaded head allows threaded rod to be securely attached, which can be further connected into a multitude suspending applications.

HANGERMATE™ rod hangers feature the same patented thread as featured on our BLUE-TIP 2 SCREW-BOLT™, giving the same easy installation and loading capacities.

- ETA Option 1 approved for cracked and uncracked concrete
- Fire rated to F120
- Patented thread for easy installation and increased productivity
- Approved for small spacing and edge distances



HANGERMATE™ ROD HANGERS

DESCRIPTION

- All steel self-tapping threaded fastening system
- For suspending steel threaded rod vertically overhead

APPLICATIONS

- Hanging pipes
- Sprinkler systems
- Lighting systems
- Suspended ceilings

MATERIALS

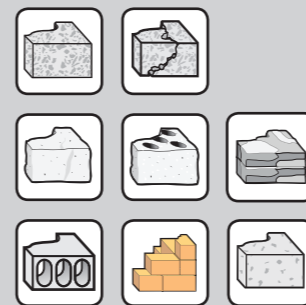

See front cover foldout for details.

APPROVALS

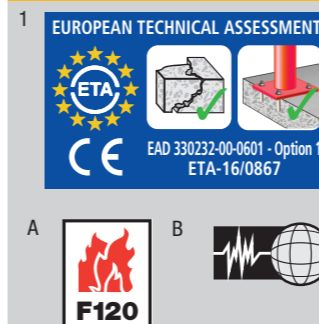

PRODUCT OVERVIEW - HANGERMATE™ ROD HANGERS

NEW



Cat No.	1	A	B	Drill Dia. [mm]	Length [mm]	Internal Thread [mm]	Box	Blister Pack	Pack Qty
DFM1450002	•	•	•	6x40		M8	•		50 + Setting Tool
DFM1450003	•	•	•	6x40		M10	•		50 + Setting Tool

INSTALLATION INSTRUCTIONS

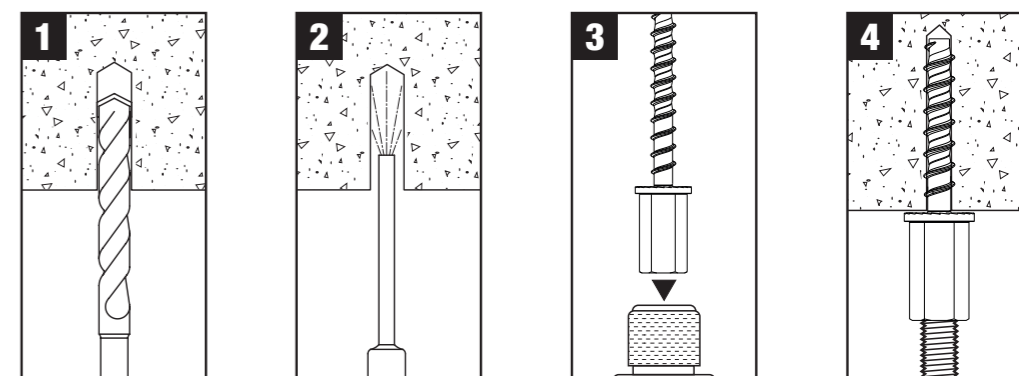

TECHNICAL INFORMATION

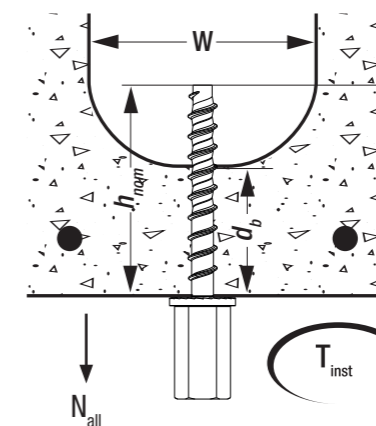

RECOMMENDED LOADS - UNCRACKED CONCRETE - HANGERMATE™ ROD HANGERS

Size - d ₀ x L [mm]	h _{nom} [mm]		h ₁ [mm]		d _f [mm]	N _{all} [kN]	
	min	max	min	max		min	max
M8 6 x 40	40	-	50	-	9	2.6	-
M10 6 x 40	40	-	50	-	9	2.6	-

ALLOWABLE LOADS - CRACKED CONCRETE - HANGERMATE™ ROD HANGERS

Size - d ₀ x L [mm]	h _{nom} [mm]		h ₁ [mm]		d _f [mm]	N _{all} [kN]	
	min	max	min	max		min	max
M8 6 x 40	40	-	50	-	9	1.2	-
M10 6 x 40	40	-	50	-	9	1.2	-