

INSTALLATION GUIDE

VERTICAL MOVEMENT JOINTS

Ancon®

Debonding sleeves are used on plain-ended wall ties, like the Ancon PP21 or PPB, at vertical movement joints. The tie will restrain the masonry against lateral wind loads whilst the sleeve will allow the masonry to expand or contract.

Debonding sleeves should be installed with a 10mm gap at the end to allow for expansion of the masonry.

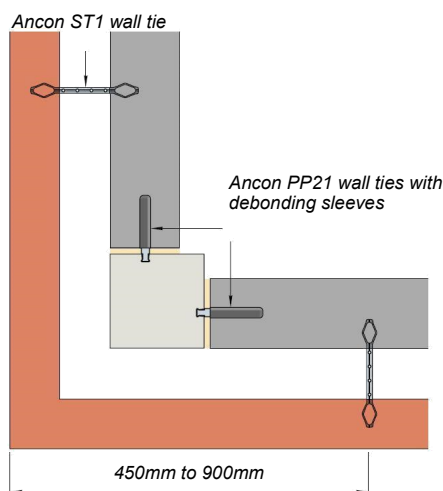
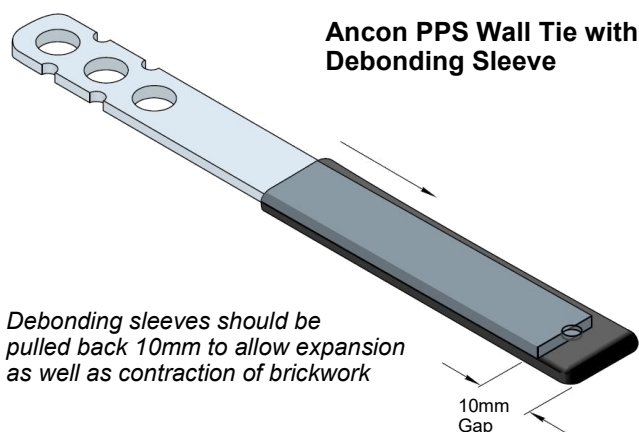

External Corner with Fully Bonded Brickwork

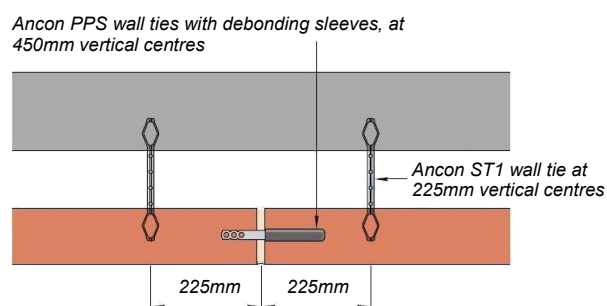

Cavity Wall with Vertical Movement Joint in Brickwork

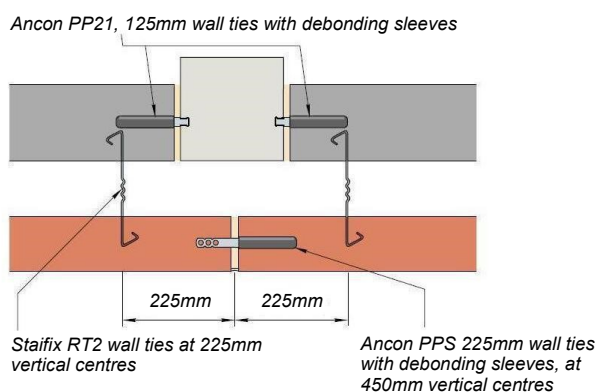

Intermediate Column with Vertical Movement Joints in both Brickwork and Blockwork

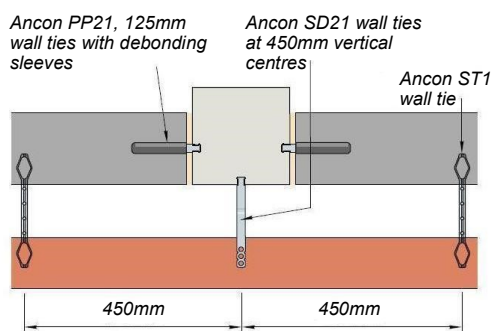

Intermediate Column with Vertical Movement Joints in Blockwork

Note: All spacings are maximums. The type of cavity wall tie and spacing will be determined by the cavity width, height of brickwork, wind loading and type of building.

© Ancon Ltd, 2018

The Construction applications and details provided in this guide are indicative only. In every case installation should be entrusted to appropriately qualified and experienced persons.

Normal handling precautions should be taken to avoid physical injury. Ancon Ltd cannot be held responsible for any injury as a result of using our products, unless such injury arises as a result of our negligence.

Ancon®

President Way, President Park, Sheffield S4 7UR
Tel: +44 (0) 114 275 5224, Fax: +44 (0) 114 276 8543
Email: info@ancon.co.uk, Visit: www.ancon.co.uk
Follow on Twitter: @AnconUK